

LINE X-X CORRESPONDS TO
LINE X-X ON DEVICE TEMPLATE

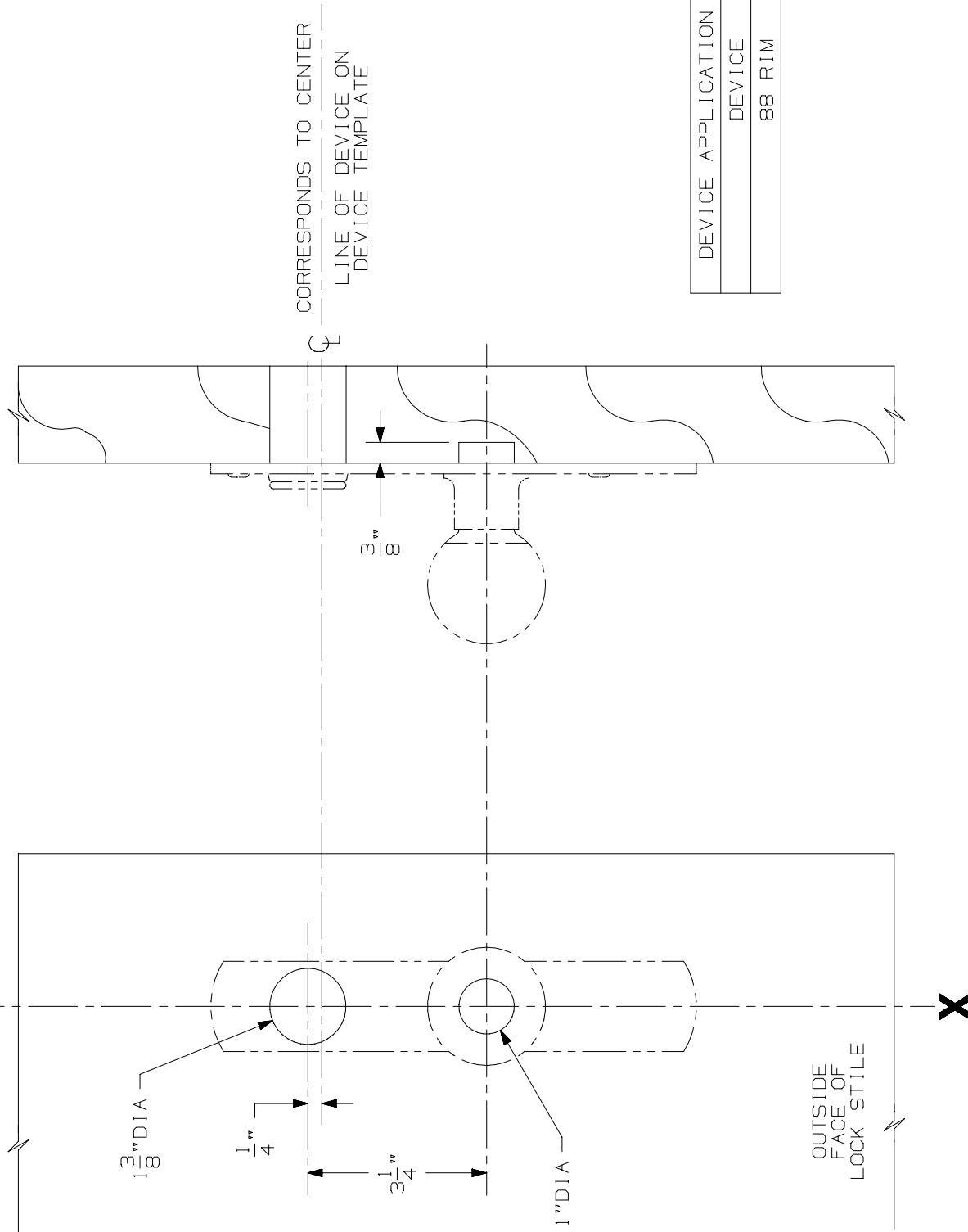

DEVICE APPLICATION SCHEDULE
DEVICE
88 RIM

LHR SHOWN
RHR OPPOSITE

NOTE: MOUNTING HOLES TO BE PREPARED
AT INSTALLATION ON DOOR.

FOR CUTOUTS ON INSIDE FACE OF DOOR
SEE DEVICE TEMPLATE.

606 KR TRIM (WOOD DOOR)
(RIGID KNOB)

IR VON DUPRIN®

NOTES:

TEMPLATE
NUMBER:

W20063_1

DATE:

10-13-98