

LINE X-X CORRESPONDS TO
LINE X-X ON DEVICE TEMPLATE

X

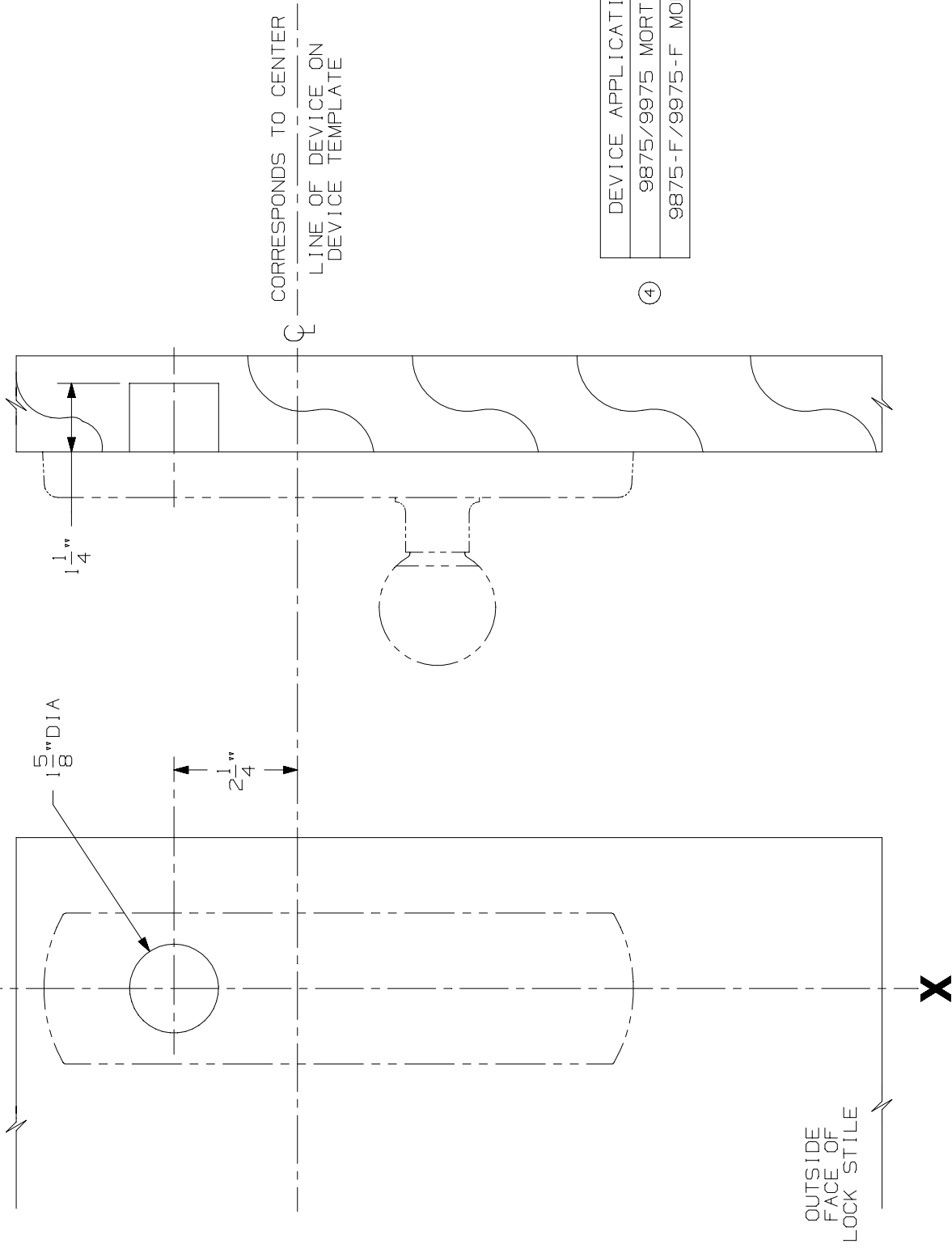

CORRESPONDS TO CENTER
LINE OF DEVICE ON
DEVICE TEMPLATE

DEVICE APPLICATION SCHEDULE
9875/9975 MORTISE DEVICE
9875-F/9975-F MORTISE DEVICE

(4)

LHR SHOWN
RHR OPPOSITE

NOTE: MOUNTING HOLES TO BE PREPARED
AT INSTALLATION ON DOOR.

FOR CUTOUTS ON INSIDE FACE OF DOOR
SEE DEVICE TEMPLATE.

991KR & 992LR TRIM (WOOD DOOR)
(RIGID)

IR VON DUPRIN®

(4)

NOTES:

TEMPLATE
NUMBER:

W20281_4

DATE:

10-15-98